



The TJ 20G rotary jet head provides 360° indexed impact cleaning over a defined time period. It is automatic and represents a guaranteed means of achieving quality assurance from cleaning tanks.

APPLICATIONS

Processing, storage and transportation tanks and vessels between 15 and 150m³ (4 000 to 39 400 US gallons). Used in breweries, food and dairy processes, chemical and many other industries. The award winning design is particularly suitable for ultra hygienic industries demanding Hygienic Equipment Design Group approval.

OPERATION

The flow of the cleaning fluid makes the nozzles perform a geared rotation around the vertical and horizontal axes. In the first cycle, the nozzles lay out a coarse pattern on the tank surface. The following cycles make the pattern gradually more dense until a full pattern is reached after 8 cycles.

CYCLE CHARACTERISTICS

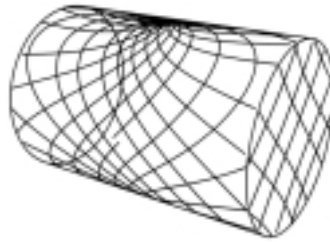

First Cycle



Full Cycle

The above drawings show the cleaning pattern achieved on a cylindrical horizontal vessel. The difference between the first cycle and the full pattern represents the number of additional cycles available to increase the density of the clean.

OPTIONS

The choice of nozzle diameters can optimise jet impact length and flow rate at the desired pressure. An electronic rotation sensor to validate 360° coverage can also be included.

SYSTEM QUALITY

The TJ 20G is approved according to the EHEDG test procedure.

ORDERING INFORMATION

Please specify nozzle size and required connections.

SPECIFICATIONS

Materials

AISI 316L, AISI 316, SAF 2205 (UNS 31803), PTFE, E-CTFE, PEEK, PVDF

Weight

5,1 kgs (11,2 lbs)

Lubricant

Self-lubricating with the cleaning fluid

Working pressure

3-8 Bar (40-115 psi)

Recommended pressure

4-7 Bar (58-100 psi)

Max. working temperature

95 °C (203 °F)

Max. ambient temperature

140 °C (284 °F)

Max. throw length

9-14 m (29-46 ft.)

Effective throw length

4-8 m (13-26 ft.). Impact in centre of jet
250 mm water column (50 lbs/sq.ft.)

Standard thread

1" BSP or NPT, Female

Min. tank opening

See dimension drawings

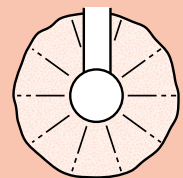

Contact our Helpline for any special requirements:
Tel: +44 (0) 151 424 6821
Fax: +44 (0) 151 495 1043
e-mail: sales@delavan.co.uk
Web: www.delavan.co.uk

FLOW RATE

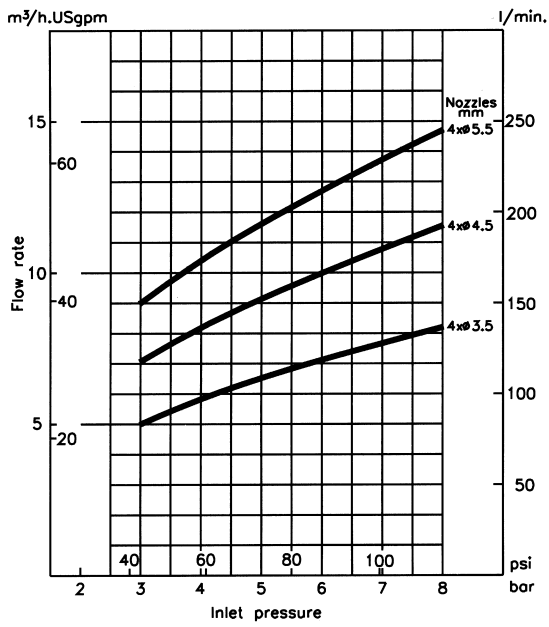

THROW LENGTH

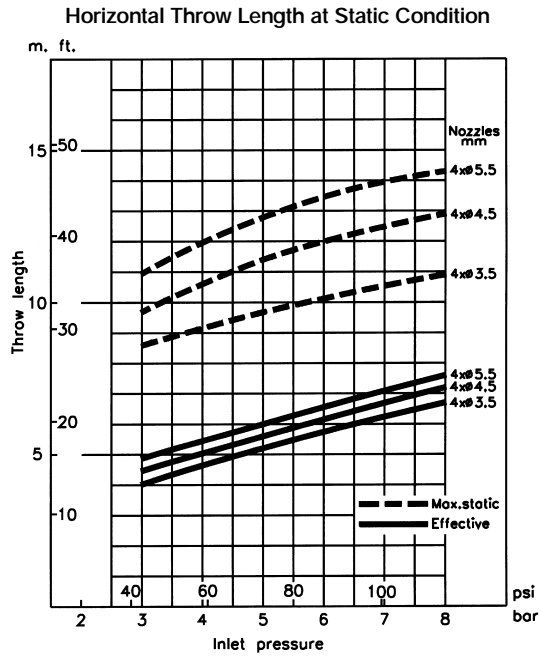

DIMENSIONS

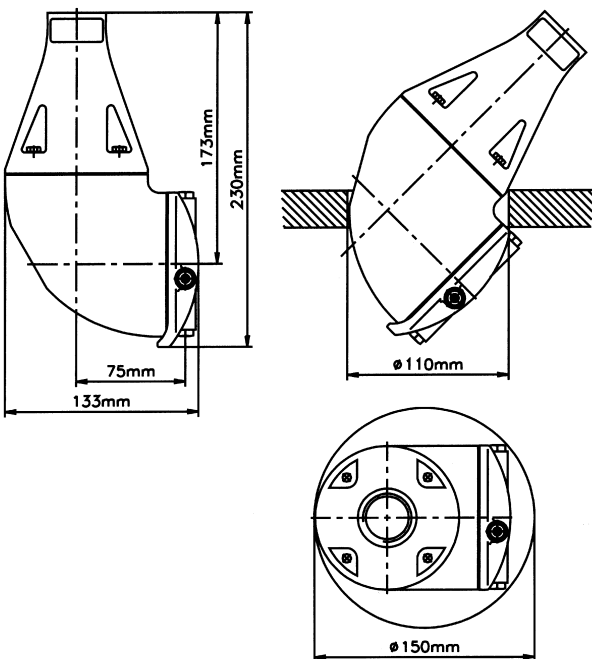

CLEANING TIME

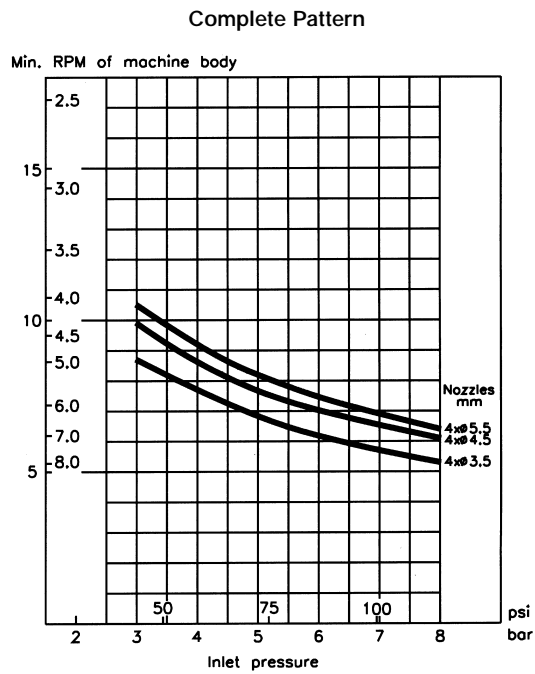

CLEANING IN PLACE

TYPE TJ 20G

Contact our Helpline for any special requirements:
Tel: +44 (0) 151 424 6821
Fax: +44 (0) 151 495 1043
e-mail: sales@delavan.co.uk
Web: www.delavan.co.uk

