



Max. Design Pressure: 350 Bar.G.
Max. Design Temperature: 150°C.

SPRAY CHARACTERISTICS

- The SDX series nozzles produce a hollow cone spray pattern with uniform particle size distribution even at low operating pressures.
- Flow rates are certified to be within $\pm 5\%$ of rated capacity at 65 Bar.G. and within $\pm 5^\circ$ of rated spray angle when tested with water.
- Unique, patented single inlet spiral swirl chamber offers increased nozzle life, improved product uniformity, density or solubility.
- Minimal friction due to nozzle design permitting 10-20% lower operating pressure than conventional slotted distributor nozzle for equivalent atomisation quality.
- Extended pump life due to lower operating pressure.
- Reduction in fine particles is possible due to lower pressure requirements.

CONSTRUCTION AND MATERIALS

- Six part construction (see part and material list below).
- O-ring seals allow assembly and disassembly without tools.
- Body and adaptors are produced from hexagon barstock with other materials in round bar with flats.
- Nozzle bodies and adaptors are available in 316 Stainless Steel. Other materials are available on special request.
- Orifice discs are easily removable and are available in Tungsten Carbide, Chrome Carbide and Ceramic.
- Swirl chambers are standard in Tungsten Carbide, Hardened Stainless Steel or Ceramic.
- End plates are available in Tungsten Carbide and Ceramic.
- Combined swirl chamber/end plate is available in Tungsten Carbide only.
- O-Rings are in Silicone or Viton.

ORDER EXAMPLE

Please indicate all component parts and materials when ordering.

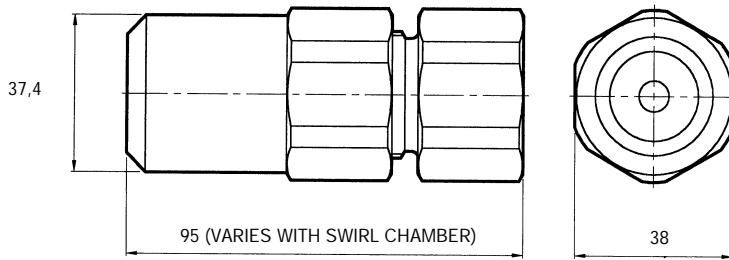

WEIGHTS

Assembly Size	Weight (g)
1/4"	743
3/8"	729
1/2"	714
3/4"	700

COMPONENT PARTS, MATERIALS AND WEIGHTS

Description	Part No.	Material	Weight (g)
Body	W11300	316 Stainless Steel	276
Orifice O-Ring	31351-66 31352-016	Silicone Viton	- -
Orifice Disc	703-XXX* 704-XXX 608-XXX	Tungsten Carbide Chrome Carbide Ceramic	11,4 11,4 -
Swirl Chamber	29794-XX*	Hardened Stainless Steel	8,5
Swirl Chamber	31212-XX	Tungsten Carbide	17
Swirl Chamber	30655-XX	Ceramic	-
Swirl Chamber with End Plate Combined	W01380-XX	Tungsten Carbide	28,4
End Plate	38331** W11430	Tungsten Carbide Ceramic	42,5 -
Adaptor O-Ring	31351-65 31351-32	Silicone Viton	- -
1/4" BSPT Female Adaptor	W11301-1	316 Stainless Steel	369
3/8" BSPT Female Adaptor	W11301-2		354
1/2" BSPT Female Adaptor	W11301-3		340
3/4" BSPT Female Adaptor	W11301-4		312

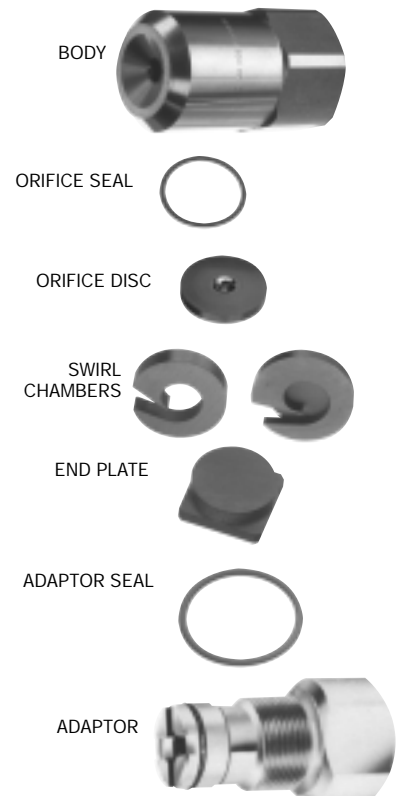

* Specify orifice size and swirl chamber suffix from capacity chart.
** End plate not required with W01380 swirl chamber.

Contact our Helpline for any special requirements:
Tel: +44 (0) 151 424 6821
Fax: +44 (0) 151 495 1043
e-mail: sales@delavan.co.uk
Web: www.delavan.co.uk

