

SPRAY CHARACTERISTICS

- Relatively uniform distribution at all pressures.
- Available in a range of flow capacities.
- Produces a full spray pattern from a multiple orifice body, with 360° spherical cover for tanks up to 3 mtrs in diameter.

CONSTRUCTION AND MATERIALS

- Manufactured with a 1½" BSPT Female threaded body fitted with 21 removable solid cone spray nozzles.
- Made in Stainless Steel, Gunmetal/Brass as standard.
- Other nozzles can be fitted to give non-standard spray patterns.
- Other materials available to special order.

ORDER EXAMPLE

1½" CIP21-500 Stainless Steel.



APPROX. DIAMETER OF COVERAGE (mm)

| Assembly Number | Pressure Bar. G. | | |
|-----------------|------------------|------|------|
| | 1,0 | 3,0 | 5,0 |
| CIP21-100/200 | 1000 | 1900 | 2000 |
| CIP21-250/400 | 1200 | 2400 | 2500 |
| CIP21-500/650 | 1500 | 2990 | 3100 |
| CIP21-750/1000 | 1700 | 3300 | 3500 |

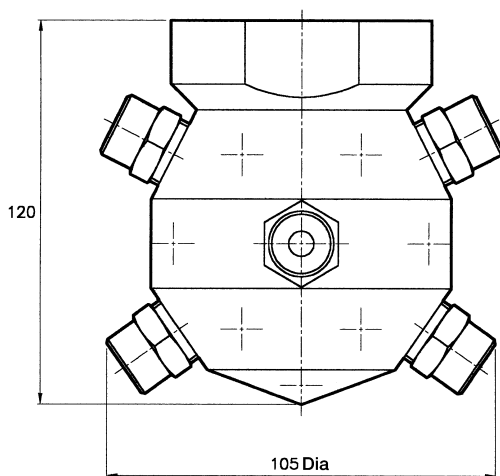

Approx. weight of assembly= 1.5Kg

Maximum Recommended Pressure:
35 Bar.G. (Metal), 7 Bar.G. (Plastic).

CAPACITY CHART

| ASSEMBLY NUMBER | NOZZLES | FLOW RATE IN LITRES/MIN AT Bar.G. | | | | | | | |
|-----------------|-----------|-----------------------------------|-------|-------|-------|-------|-------|-------|-------|
| | | 0,7 | 1,0 | 2,0 | 3,0 | 4,0 | 5,0 | 6,0 | 7,0 |
| 1.½" CIP21-150 | ¼" BIM 6 | - | 31,50 | 45,78 | 55,64 | 60,26 | 67,37 | 71,61 | 74,34 |
| 1.½" CIP21-200 | ¼" BIM 8 | - | 47,87 | 67,83 | 83,98 | 95,55 | 104,8 | 112,9 | 120,1 |
| 1.½" CIP21-250 | ¼" BIM 12 | - | 71,61 | 95,54 | 111,2 | 124,1 | 138,7 | 147,4 | 159,1 |
| 1.½" CIP21-300 | ⅜" BIM 12 | 58,59 | 69,72 | 99,33 | 122,4 | 138,6 | 154,9 | 163,5 | 171,5 |
| 1.½" CIP21-400 | ⅜" BIM 16 | 75,18 | 92,61 | 128,9 | 152,6 | 167,9 | 187,7 | 199,7 | 210,8 |
| 1.½" CIP21-500 | ⅜" BIM 22 | 107,3 | 131,1 | 174,7 | 205,3 | 229,1 | 256,1 | 277,8 | 298,9 |
| 1.½" CIP21-650 | ⅜" BIM 27 | 126,8 | 155,8 | 211,9 | 258,7 | 286,4 | 320,1 | 337,2 | 366,6 |
| 1.½" CIP21-750 | ⅜" BIM 32 | 152,1 | 186,5 | 258,7 | 303,2 | 335,1 | 374,6 | 405,1 | 428,2 |
| 1.½" CIP21-1000 | ⅜" BIM 42 | 203,1 | 242,8 | 335,2 | 405,1 | 449,6 | 478,3 | 524,0 | 574,8 |

CLEANING IN PLACE

TYPE CIP 21

Contact our Helpline for any special requirements:
Tel: +44 (0) 151 424 6821
Fax: +44 (0) 151 495 1043
e-mail: sales@delavan.co.uk
Web: www.delavan.co.uk

